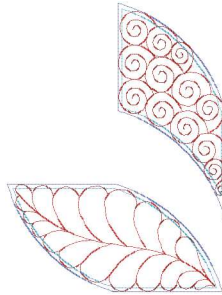
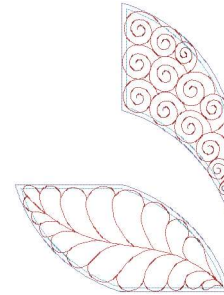
**Design1 - 5x7.vip**

5.07x6.70 inches; 3,329 stitches  
6 thread changes; 3 colors

**Design1 - 6x10.vip**

6.09x8.04 inches; 3,757 stitches  
6 thread changes; 3 colors

**Design1 - 7x11.vip**

6.99x9.41 inches; 4,152 stitches  
6 thread changes; 3 colors

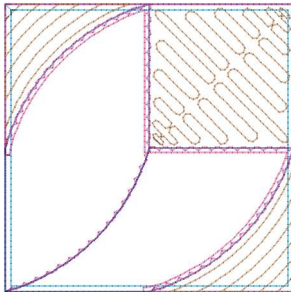
**Design2 - 5x7.vip**

5.01x5.00 inches; 1,894 stitches  
8 thread changes; 5 colors

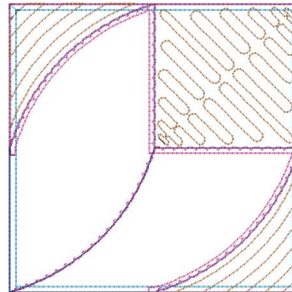
**Design2 - 6x10.vip**

6.00x6.00 inches; 2,256 stitches  
8 thread changes; 5 colors

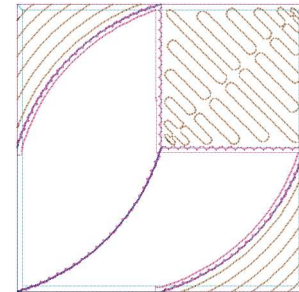
**Design2 - 7x11.vip**

7.00x7.00 inches; 2,598 stitches  
8 thread changes; 5 colors

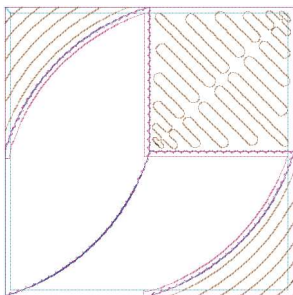

**Design2 - 8x12.vip**

7.84x7.84 inches; 2,889 stitches  
8 thread changes; 5 colors

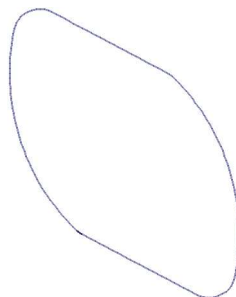

**DI - 5x7 - Part 1.vip**

4.40x5.54 inches; 179 stitches  
1 thread changes; 1 colors

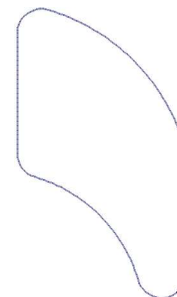

**DI - 5x7 - Part 2.vip**

3.50x6.00 inches; 180 stitches  
1 thread changes; 1 colors

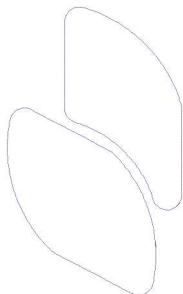

**DI - 6x10.vip**

5.96x9.94 inches; 409 stitches  
1 thread changes; 1 colors

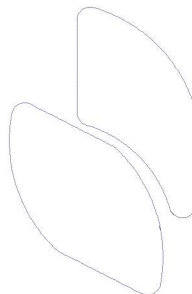

**DI - 7x11.vip**

7.06x10.92 inches; 458 stitches  
1 thread changes; 1 colors