



NYC
MEA



Aqualite™ keypads —

**Classic function
meets innovative
design.**



Aqualite's cool blue radiance delivers high-tech design to any residential or commercial installation. The Aqualite™ keypads are loaded with the same flexible features as standard DMP keypads.

- Visual and audible alarm notification
- Silence alarm while system remains armed
- Optional integrated proximity reader
- Four optional on-board fully programmable zones
- Retrofit to any DMP panel

Enhanced Options

7063A and 7073A keypad proximity readers accept DMP/HID 1300 Series proximity credentials.

AQUALITE LCD KEYPADS 7060A/7063A/7070A/7073A

FEATURES

- Attractive Aqualite keypad housing available in three colors
- Large, 32-character, blue Liquid Crystal Display (LCD)
- Custom 16-character home or business name
- Keypad and logo backlighting turns Red in alarm conditions
- User-adjustable brightness, tone, and volume controls
- Cancel/Verify™ feature supported
- Built-in diagnostics for ease of service
- Simple harness connection to 4-wire keypad bus
- Connect devices directly to keypad zones
- View system events/user activity through keypad display
- AC power and Armed LEDs
- Suitable for access, burglary, and fire applications
- Distinct fire, burglary, zone monitor, and prewarn tones
- Displays time of day, armed zones, and armed areas
- Optional backboxes for conduit or wall-mount applications
- User-safety feature allows the user to silence alarm bells and still keep the system armed
- Compatible with all DMP panels

VERSATILE SUPERVISED AND UNSUPERVISED OPERATION

When programmed for supervised operation, the keypad occupies its own unique device address on the keypad data bus.

Unsupervised operation allows you to install an unlimited number of keypads set to the same device address. Increasing the number of keypads allows maximum system operating flexibility.

USER-FRIENDLY MENU FUNCTIONS

The User Menu allows you to quickly browse through menu options. Disarming and Arming functions are fast and easy. Any function allowed by the user authority level is simply accessed through the keypad, such as silencing alarms, resetting sensors, or displaying events.

2-BUTTON PANIC KEYS

The top row of keys can be programmed as 2-button panic keys. The user simply presses and holds two of the keys simultaneously to send either a panic, non-medical emergency, or fire report to the Central Station.

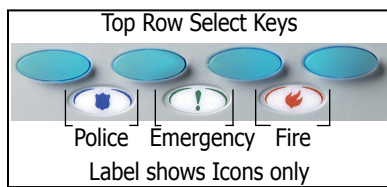

Panic Key Labels

CANCEL/VERIFY

In a Home/Sleep/Away or All/Perimeter system, you can CANCEL a burglary alarm or VERIFY that a valid burglar alarm has occurred. Selecting VERIFY manually verifies the alarm and sends an alarm verification message to the Central Station.

END-USER CONTROL

Each of the Aqualite Series keypads provides a simple User Options menu for adjusting brightness, speaker tone, and volume.

VALUABLE VISUAL ALARM INDICATOR

In a normal state, both the keypad and logo backlighting remain *Blue*. However, during an alarm state, the keypad and logo turn *Red*. The change in color allows persons on-site to instantly recognize an alarm condition.



Red Backlighting for Alarm Conditions



Blue Backlighting for Normal State

DISTINCT SOUND PATTERNS

The keypads also provide distinct sound patterns for fire, burglary, zone monitor, and prewarn that can help users identify the event occurring on their system.

RETROFIT ANY EXISTING DMP SYSTEM

Retrofitting is quick and easy. Aqualite keypads have the same footprint as existing DMP keypads and mount on currently installed backboxes. Aqualite Series keypads require no special modules or panel upgrades. You can provide a new look and greater functionality to an existing system at just a fraction of the cost of all new equipment.

MULTIPLE-KEYPAD SAVINGS

Install multiple keypads on the same wire run. Compatibility and cost savings make the Aqualite Series an asset in every installation.

OPTIONS

The Aqualite Series keypads also provide Keypad Options and Keypad Diagnostics menus available only to system installers and service technicians. Enter Keypad Options to set the keypad address and change the default keypad message.

Test the keypad operation at any time without disabling the system. The diagnostics program tests the LCD segments and backlighting, each of the 16 keyboard keys, and the four zones on the 7070A and 7073A keypads.

UNIVERSAL PROGRAMMING TOOL

System installation and programming can be achieved without carrying around or purchasing expensive external programmers since panel and add-on module programming is integrated into DMP Keypads.

Individually program panels, iCOM Network Alarm Router, iCOM_{SL} Network Alarm Communicator, and other programmable add-on modules directly from the keypad.

7070A/7073A FOUR EXPANSION ZONES

Zone expansion is available right on the keypad where you need it the most. The four expansion zones on the 7070A and 7073A models are fully programmable Class B protection zones that can be used for a variety of fire, burglary, and access control applications.

ZONE TYPE SELECTION

Keypad zones can be programmed using the same zone types available on the panel. Select supervised, unsupervised, night, fire, panic, exit, and emergency operation depending on the user requirements.

KEYPAD MODEL FEATURES

Model	2-Button Panic	Red in Alarm	4-Zones	Internal Prox Reader	Wiegand Input	Internal Form C Door Strike Relay
7060A	X	X				
7063A	X	X		X		
7070A	X	X	X			
7073A	X	X	X	X	X	X

ZONE DEVICE CHOICES

Connect PIRs, door and window contacts, pull stations, sprinkler tamper switches, and silent panic buttons. Plan the installation to afford the best coverage while eliminating potential problems associated with multiple wire runs.

7063A/7073A CODELESS ARMING AND DISARMING

The innovative 7063A and 7073A Aqualite keypads contain an on-board DMP proximity reader that allows users to simply present their proximity credentials to the keypad to gain access to a protected area.

7073A SOFT-SHUNT® MOMENTARY BYPASS

To provide an entry and exit window on systems with 24-hour perimeter protection, DMP offers the Soft-Shunt® feature. Soft-Shunt allows the user enough time to enter or exit the area. If the door remains open when the timer expires, a zone open/short is sent to the panel for the keypad Zone 2.

REQUEST-TO-EXIT (REX)

To enable easy user exit from an area, connect a motion sensing or mechanical device to Zone 3 on the keypad. As the user trips the zone, the keypad activates the door strike allowing the user to exit the area without presenting a card or entering a user code.

PRIVATE LABELING

DMP offers dealers the option to present their company logo on the Aqualite Series keypads. The logo displays on the rubber logo insert and replaces the DMP logo. The backlighted logo glows *Blue* during normal operation and turns *Red* in an alarm state.



AQUALITE™ LCD KEYPADS

KEYPAD ACCESSORIES

Backboxes

- 695 Keypad Conduit Backbox
- 696 Keypad Backbox

Keypad Wiring Harness

- 300 4-wire harness
- 300-5 5-wire harness
- 300-12 12-wire harness
- 300-512 12-wire harness, 5 ft. long

Proximity Credentials

- 1306 Prox Patch™
- 1306PW Prox Patch™
- 1326 ProxCard II® Card
- 1346 ProxKey II® Access Device
- 1351 ProxPass®
- 1386 ISOProx II® Card

External Proximity Readers

- PP-6005B ProxPoint® Plus Proximity Reader
- MP-5365 MiniProx™ Proximity Reader
- PR-5455 ProxPro® II Proximity Reader
- MX-5375 MaxiProx® Proximity Reader
- TL-5395 ThinLine II® Proximity Reader

KEYPAD ORDERING INFORMATION

The Aqualite Series keypads are available in White, Platinum or Black to complement any decor. Select from the following options:

- 7060A-W
- 7063A-W
- 7070A-W
- 7073A-W



- 7060A-P
- 7063A-P
- 7070A-P
- 7073A-P



- 7060A-B
- 7063A-B
- 7070A-B
- 7073A-B



SPECIFICATIONS

- Operating Voltage 12 VDC
- Dimensions 7" W x 5.25" H x 0.5" D
- Display Type LCD (Blue)

COMPATIBILITY

7000 Aqualite Series keypads are compatible with all DMP panels. Aqualite keypads are not available in a Fire Keypad Variation.

CURRENT DRAW

- 7060A Standby 72mA
- Alarm 87mA
- 7063A Standby 85mA
- Alarm 100mA
- 7070A Standby 72mA + 1.6mA per active zone
- Alarm 87mA + 2mA per active zone
- 7073A Standby 85mA + 1.6mA per active zone
- Alarm 100mA + 2mA per active zone

LISTINGS AND APPROVALS

- Underwriters Laboratory (UL) Listed
- UL 294 Access Control System Units
- UL 365 Police Connected Burglar
- UL 609 Local Burglar
- UL 1023 Household Burglar
- UL 1076 Proprietary Burglar
- UL 1610 Central Station Burglar
- UL 985 Household Fire Warning
- UL 864 Fire Protective Signaling

New York City (MEA)

California State Fire Marshal (CSFM)

FCC Part 15 RFID Reader FCC ID: CCKPC0086

IC Registration ID: 5251A-PC0086

For additional information, access www.dmp.com and select Compliance



800-641-4282

www.dmp.com

Made in the USA

INTRUSION • FIRE • ACCESS • NETWORKS

2500 North Partnership Boulevard

Springfield, Missouri 65803-8877

